

Drawing Notes:

Structural substrates shown in this drawing are for illustrative purposes only.

Note A:

Lightning cable clips should be installed at no greater than 1000mm centres, unless otherwise specified by the provided of the lightning protection services.

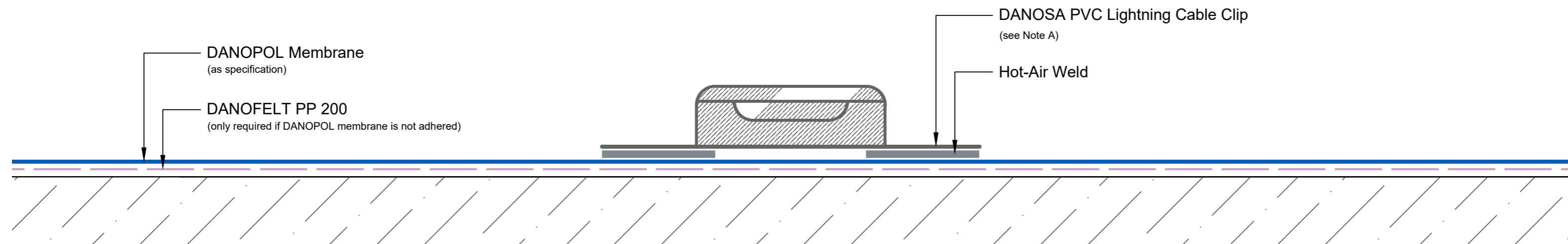

Drawing Number: DUK-S-(G)-340C	Revision: 00
Date Drawn: March 2017	Author: SL

Drawing Title:
Lightning Conductor Clip
DANOPOL® Single Ply Membranes - Cold Roof



Building together

DANOSA UK Limited

Tel: 0845 074 0553 | www.danosa.co.uk | uktechnical@danosa.com