



WATERPROOFING SOLUTIONS FOR **WET AREAS**

WATERPROOFING, INSULATION AND MORTARS

INVISIBLE COMFORT

SOLUTIONS FOR NEW BUILDS
AND RENOVATIONS



WATERPROOFING



ENERGY SAVINGS
THERMAL INSULATION



NOISE PROTECTION
ACOUSTIC INSULATION



MORTARS



NATURAL LIGHTING



TECHNICAL ASSISTANCE



RENOVATION



SUSTAINABILITY

DANOSA TECHNICAL ASSISTANCE SERVICES



WET AREAS

In any building, the components that can cause damp if not given the right attention, including balconies, terraces, windowsills, exposed façades, facing stonework, bathrooms, shower trays and kitchens, must be carefully considered.

In these kinds of components, a detailed study must be carried out and waterproofing must be installed with the right products and solutions to ensure damp will not appear or spread.



CONTENTS



SYSTEMS

PRODUCTS

- ✓ High flexibility
- ✓ Maximum resistance to negative pressure
- ✓ Compatible with potable water

- ✓ Maximum flexibility
- ✓ High resistance to negative pressure
- ✓ Compatible with potable water

- ✓ Excellent elasticity
- ✓ Ready to use

WINDOWSILL WATERPROOFING

Waterproofing: Ready-to-use cementitious membrane
Thermal insulation: Exterior thermal insulation system (ETICS)



ALF1

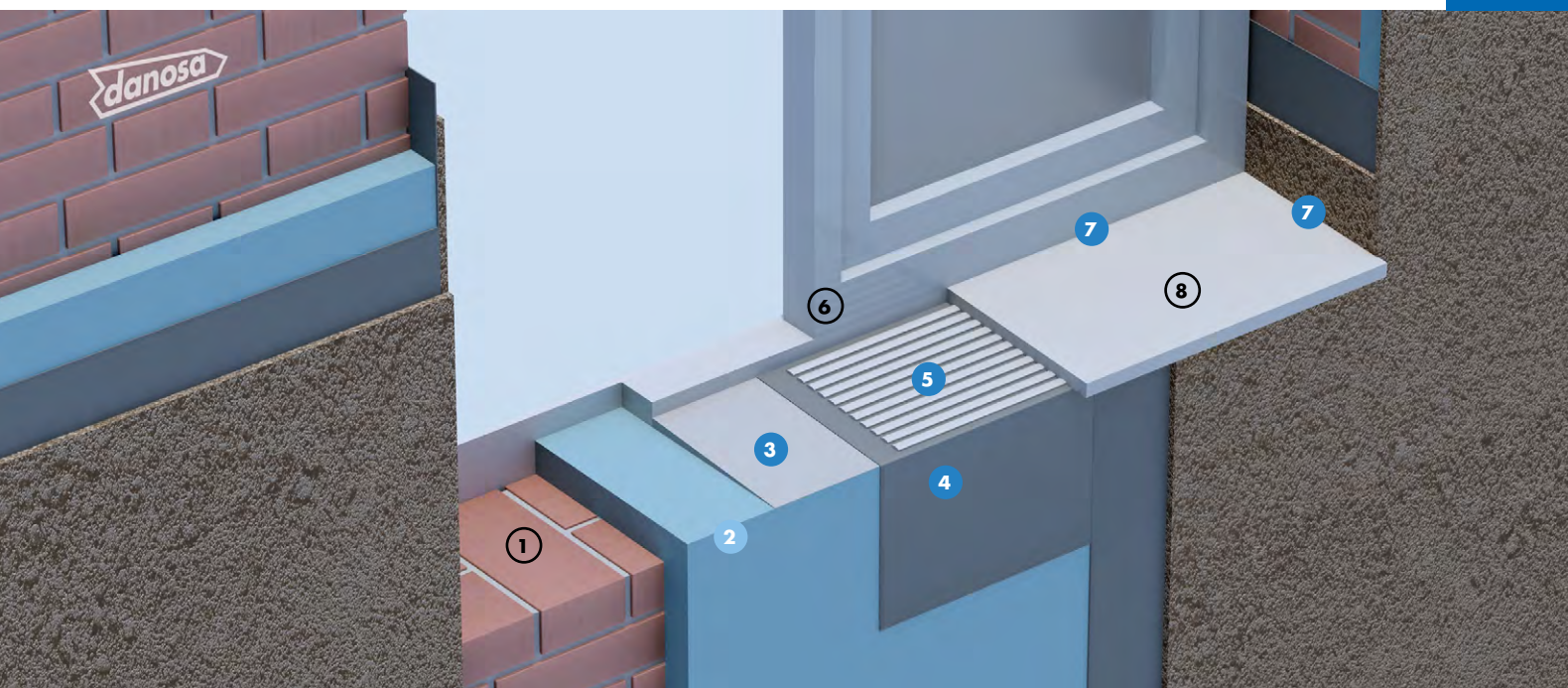

WATERTIGHTNESS
DANOCRET® PROTECT FLEX 300 or 500
or **REVESTIDAN® INDOOR**

ENERGY SAVINGS
DANOTHERM® XPS ETICS

ADVANTAGES

- Minimal thickness.
- Compatible with cementitious adhesive.
- Maximum adherence.
- Maximum waterproofing.
- Quick to install.
- Solution suitable for all types of enclosures.

APPLICATION

- All windowsills.
- Wall bases to prevent rising damp.

KEY

Façade

- ① Façade enclosure
- ② Exterior thermal insulation system DANOTHERM® XPS (See system FCH1)
- ③ Sloping mortar ARGOSEC® M-7.5 B
- ④a One-component cementitious waterproofing membrane DANOCRET® Protect 300 Flex
- ④b Two-component cementitious waterproofing membrane DANOCRET® Protect 500 Flex
- ④c Liquid waterproofing REVESTIDAN® Indoor
- ⑤ Cementitious adhesive ARGOCOLA® Elite 500
- ⑥ Window frame
- ⑦ Elastic seal ELASTYDAN® PU 40 Grey
- ⑧ Windowsill

* Check for mandatory gradient of >2%.

Important joints with carpentry do not block the drain.

Important to waterproof > 20 cm at jambs.

Suitable at top of parapets under coping or crown piece.

WINDOWSILL WATERPROOFING

Waterproofing: Ready-to-use cementitious membrane
Thermal insulation: Exterior thermal insulation system (ETICS)



TECHNICAL SPECIFICATIONS

Function	Product	Description	Property	Value
Thermal insulation	DANOTHERM® XPS ETICS	Exterior thermal insulation system (ETICS) using extruded polystyrene boards (XPS)	Thickness > 40 mm (ETA no. 18/1016)	
Cementitious adhesive	ARGOSEC® M-7.5 B	Dry mortar for bricklaying.	Performance	20 kg/m ² and cm of thickness
Waterproofing	DANOCRET® PROTECT 300 FLEX	Flexible, one-component waterproofing mortar.	Resistant to cracking EN 1062-7	Class A4 (Fissures up to 1.26 mm)
	DANOCRET® PROTECT 500 FLEX	Flexible, two-component waterproofing mortar.	Resistant to cracking EN 1062-7	Class A5 (Fissures up to 2.50 mm)
	REVESTIDAN® INDOOR	Latex resin-based elastic liquid membrane.	Resistant to cracking EN 1062-7	Class A5 (Fissures up to 3.42 mm)
Cementitious adhesive	ARGOCOLA® ELITE 500	Adhesive cement to fix insulation products.	EN 12004	C2TES1

WORK UNIT

Windowsill waterproofing comprising:

Sloping mortar ARGOSEC® M-7.5 B , manual application of two intersecting coats of two-component flexible waterproofing mortar DANOCRET® Protect 500 Flex, or one-component flexible waterproofing mortar DANOCRET® Protect 300 Flex, or one-component elastic liquid membrane REVESTIDAN® Indoor, according to UNE EN 14891 and DB-HS.

Including proportional part of the support preparation with gradient towards the exterior >2 %, direct installation of the windowsill (ceramic, concrete or polymer concrete) with cementitious adhesive ARGOCOLA® Elite 500 C2TES1 according to UNE EN 12004 and sealing of the windowsill to the facing and window frame with ELASTYDAN® PU 40 Grey respecting the drain of the window frame.

REV00-02/2023

WET AREAS INSIDE THE BUILDING

Waterproofing: Ready-to-use cementitious/liquid membrane

Finish: Flooring



HUM2

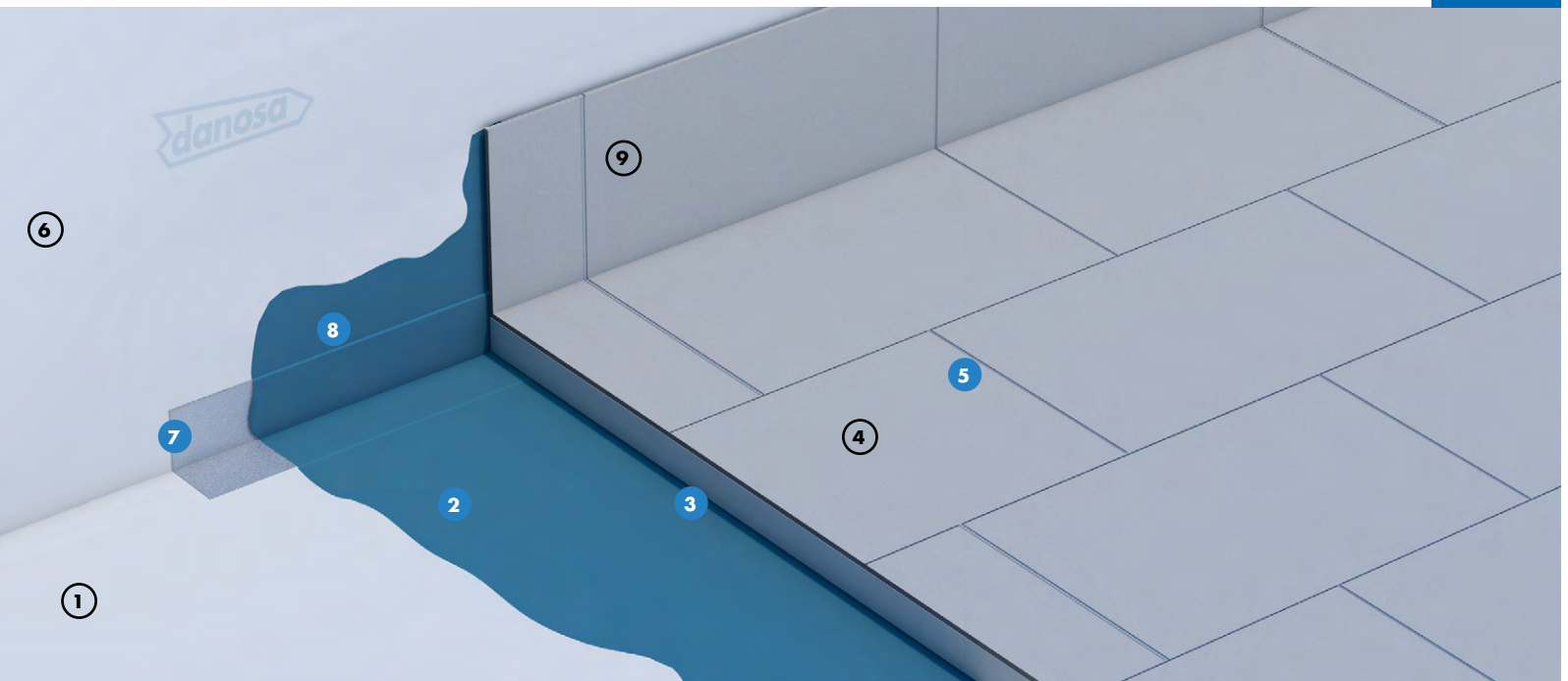

WATERTIGHTNESS DANOCRET® PROTECT 300 FLEX or 500 FLEX or REVESTIDAN® INDOOR

ADVANTAGES

- Waterproofing with no joins or overlaps.
- Crack bridging.
- Support protection.
- Fast-drying.
- Easy to apply.
- Resistant to alkaline substrates.

APPLICATION

- Waterproofing flooring before installation of the final cladding: bathrooms, showers, kitchens, etc.
- Waterproofing walls before installation of the final cladding.

RECOMMENDATIONS

- Consult the [ANFAPA ceramic tiles installation manual](#) here



*Use the product diluted 50% in water as a primer for highly absorbent supports.

KEY

Wet area:

- ① Waterproofing support
- 2a One-component cementitious waterproofing membrane DANOCRET® Protect 300 Flex
- 2b Two-component cementitious waterproofing membrane DANOCRET® Protect 500 Flex
- 2c Liquid waterproofing REVESTIDAN® Indoor*
- ③ Cementitious adhesive ARGOCOLA® Elite 500
- ④ Ceramic paving
- ⑤ Grout ARJUNT® Universal

Perimeter:

- ⑥ Wall
- 7a Reinforcing band DANOBAND® Butyl
- 7b Mortar half-pipe ARGOTEC® Repair R3
- 8a One-component cementitious waterproofing membrane DANOCRET® Protect 300 Flex
- 8b Two-component cementitious waterproofing membrane DANOCRET® Protect 500 Flex
- 8c Liquid waterproofing REVESTIDAN® Indoor
- ⑨ Protective base

WET AREAS INSIDE THE BUILDING

Waterproofing: Ready-to-use cementitious/liquid membrane
Finish: Flooring



TECHNICAL SPECIFICATIONS

Function	Product	Description	Property	Value
Waterproofing	DANOCRET® PROTECT 300 FLEX	Flexible, one-component waterproofing mortar.	Resistant to cracking EN 1062-7	Class A4 (Fissures up to 1.26 mm)
	DANOCRET® PROTECT 500 FLEX	Flexible, two-component waterproofing mortar.	Resistant to cracking EN 1062-7	Class A5 (Fissures up to 2.50 mm)
	REVESTIDAN® INDOOR	Latex resin-based elastic liquid membrane.	Resistant to cracking EN 1062-7	Class A5 (Fissures up to 3.42 mm)
Cementitious adhesive	ARGOCOLA® ELITE 500	Deformable cementitious adhesive C2TE S1.	Performance	6 kg/m²
Grout	ARJUNT® UNIVERSAL	Grout for ceramics CG2 AW.	Performance	0.64 kg/m²

WORK UNIT

Protection of wet areas comprising:

In highly absorbent supports, liquid primer REVESTIDAN® Indoor diluted 50% in water; two-component flexible waterproofing membrane DANOCRET® Protect 300 Flex, or one-component DANOCRET® Protect 500 Flex, or ready-to-use REVESTIDAN® Indoor, 2 kg/m², in two coats; ready to install flooring.

Includes proportional part of: joins with facing raising waterproofing 20 cm on the vertical, formed by: liquid primer

REVESTIDAN® Indoor diluted 50% in water, if necessary; reinforcing strip on parapet with DANO BAND® BUTYL or half-pipes with fibre-reinforced, shrink-proof mortar ARGOTEC® Repair R3; two-component flexible waterproofing membrane DANOCRET® Protect Flex 2C, or one-component DANOCRET® Protect Flex 1C, or ready-to-use REVESTIDAN® Indoor, 2 kg/m², in two coats.

Products bearing the European CE marking.

REV00-02/2023

BALCONIES AND TERRACES WITH CEMENTITIOUS MEMBRANE AND PAVING



TPP6

Waterproofing: Ready-to-use cementitious/liquid membrane
Finish: Ceramic paving

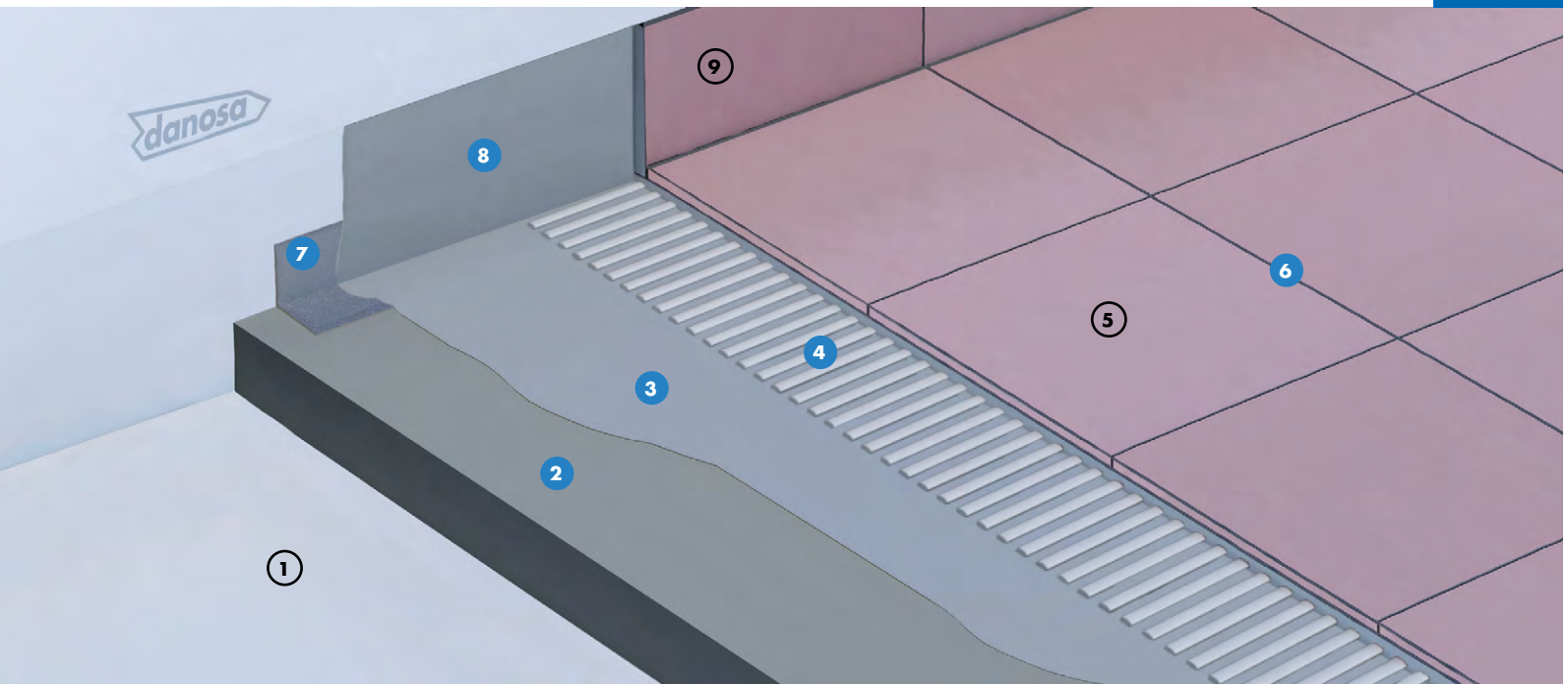

WATERTIGHTNESS DANOCRET® PROTECT 300 FLEX or 500 FLEX or REVESTIDAN® INDOOR

ADVANTAGES

- Highly elastic, highly durable waterproofing.
- Compatible with cementitious adhesive.
- Waterproofing with minimal thicknesses on slopes and flooring.
- Waterproofing suitable for complex geometries.
- Easy to apply.
- Situations with height issues, especially in renovations.
- Solution suitable for roofs with ceramic facing finish.

APPLICATION

- Logistics and industrial buildings.
- Publicly used buildings: shopping centres.
- Public or private residential buildings.
- Educational buildings: schools, universities, nurseries.
- Administrative and corporate buildings.
- Sanitary buildings: hospitals, clinics, health centres, homes.

KEY

Roof:

- ① Waterproofing support
- ② Screed mortar ARGOSEC® M-25 Elite
- ③a One-component cementitious waterproofing membrane DANOCRET® Protect 300 Flex
- ③b Two-component cementitious waterproofing membrane DANOCRET® Protect 500 Flex
- ③c Liquid waterproofing REVESTIDAN® Indoor
- ④ Cementitious adhesive ARGOCOLA® Elite 500
- ⑤ Ceramic paving
- ⑥ Grout ARJUNT® Universal

Perimeter:

- ⑦ Reinforcing band DANO BAND® Butyl
- ⑧a One-component cementitious waterproofing membrane DANOCRET® Protect 300 Flex
- ⑧b Two-component cementitious waterproofing membrane DANOCRET® Protect 500 Flex
- ⑧c Liquid waterproofing REVESTIDAN® Indoor
- ⑨ Protective base

BALCONIES AND TERRACES WITH CEMENTITIOUS MEMBRANE AND PAVING



Waterproofing: Ready-to-use cementitious/liquid membrane
Finish: Ceramic paving

TECHNICAL SPECIFICATIONS

Function	Product	Description	Property	Value
Support	ARGOSEC® M-25 Elite	Low-shrinkage projected structural rendering.	Performance	100 kg/m ²
Waterproofing	DANOCRET® PROTECT 300 FLEX	Flexible, one-component waterproofing mortar.	Resistant to cracking EN 1062-7	Class A4 (Fissures up to 1.26 mm)
	DANOCRET® PROTECT 500 FLEX	Flexible, two-component waterproofing mortar.	Resistant to cracking EN 1062-7	Class A5 (Fissures up to 2.50 mm)
	REVESTIDAN® INDOOR	Latex resin-based elastic liquid membrane.	Resistant to cracking EN 1062-7	Class A5 (Fissures up to 3.42 mm)
Cementitious adhesive	ARGOCOLA® ELITE 500	Deformable cementitious adhesive C2TE S1.	Performance	6 kg/m ²
Grout	ARJUNT® UNIVERSAL	Grout for ceramics CG2 AW.	Performance	0.64 kg/m ²

WORK UNIT

Waterproofing of balconies, terraces or roofs with complex geometries to receive a ceramic finish comprising:

Cementitious adhesive according to UNE EN 14891 comprised of minimal slope of 2% done with mortar ARGOSEC® M-25 Elite if the thickness <20 mm or traditional for greater thicknesses. Application of two-component flexible waterproofing membrane DANOCRET® Protect 500 Flex, or one-component DANOCRET® Protect 300 Flex, or ready-to-use REVESTIDAN® Indoor in its provision according to technical data sheets, carrying out

mandatory half-pipes or installing the self-adhesive perimeter strip DANO BAND® BUTYL. Installation of the ceramics with ARGOCOLA® Elite 500 C2TES1 according to UNE EN 12004-2 with a joint width >3 mm done with the buttering and floating method and ARJUNT® Universal CG2 AW as a grouting material.

Work unit measurement carried out.

RECOMMENDATIONS

- Consult the [ANFAPA ceramic tiles installation manual](#) here



REV00-02/2023

RISING DAMP WATERPROOFING

Waterproofing: Cementitious membrane

Finish: Ceramic paving

Support: Concrete, mortar

Wall: Masonry



CAP1

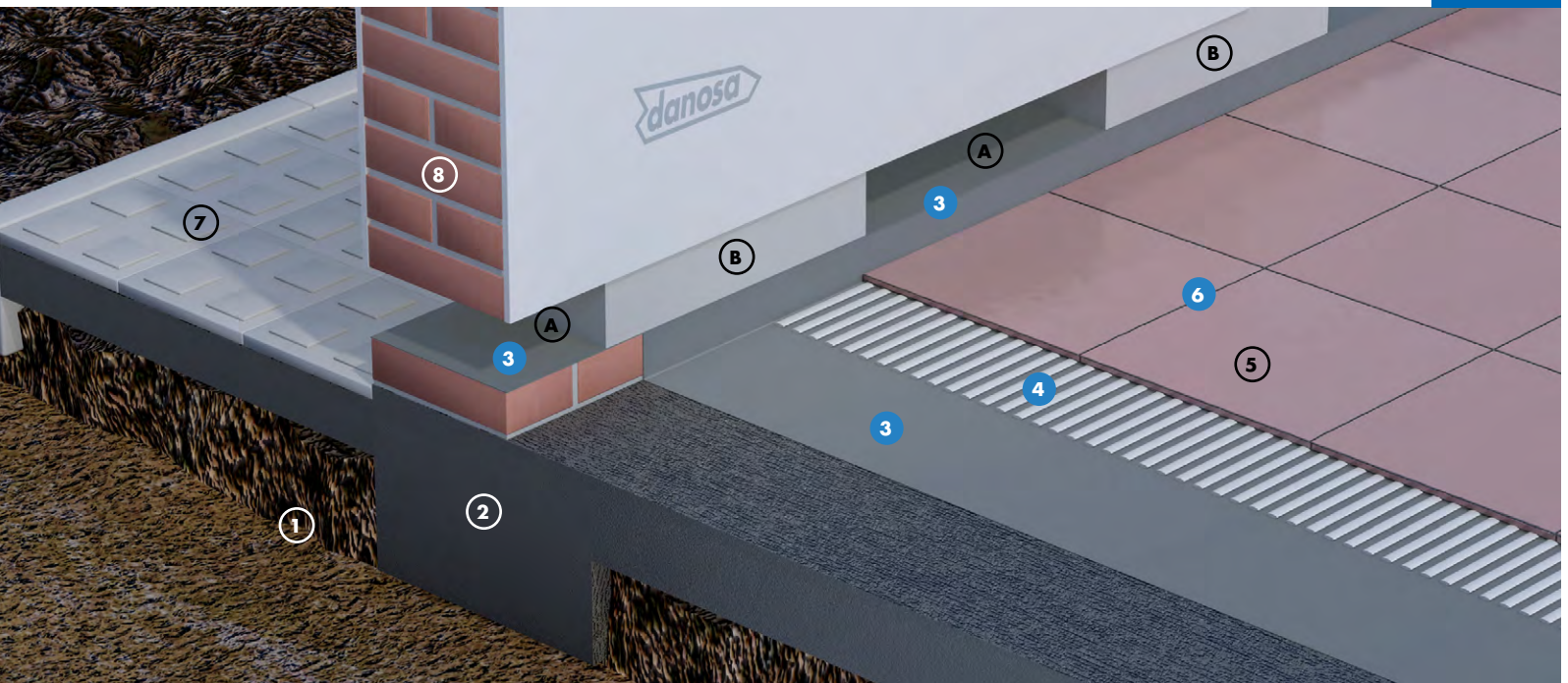

WATERTIGHTNESS DANOCRET® PROTECT 300 FLEX or 500 FLEX

ADVANTAGES

- Minimal thickness.
- Compatible with cementitious adhesive.
- Compatible with any brick masonry.
- Maximum adherence.
- Full removal of rising damp.

APPLICATION

- Listed buildings affected by rising damp.
- Buildings with load-bearing walls.
- Paving in contact with the soil affected by capillarity.

RECOMMENDATIONS

- Consult the [ANFAPA ceramic tiles installation manual](#) here



KEY

Ground:

- ① Soil
- ② Concrete
- 3a One-component cementitious waterproofing membrane DANOCRET® Protect 300 Flex
- 3b Two-component cementitious waterproofing membrane DANOCRET® Protect 500 Flex
- ④ Cementitious adhesive ARGOCOLA® Elite 500
- ⑤ New ceramic paving
- ⑥ Grout ARJUNT® Universal
- ⑦ Pavement

Wall:

- ⑧ Masonry wall
- A B Discontinuous trenches in the wall to create waterproof barrier

*Qualified workmanship is required to create the trenches for the walls marked A and B.

######

LIFT SHAFT

Waterproofing: Waterproof cementitious membrane



FOSI

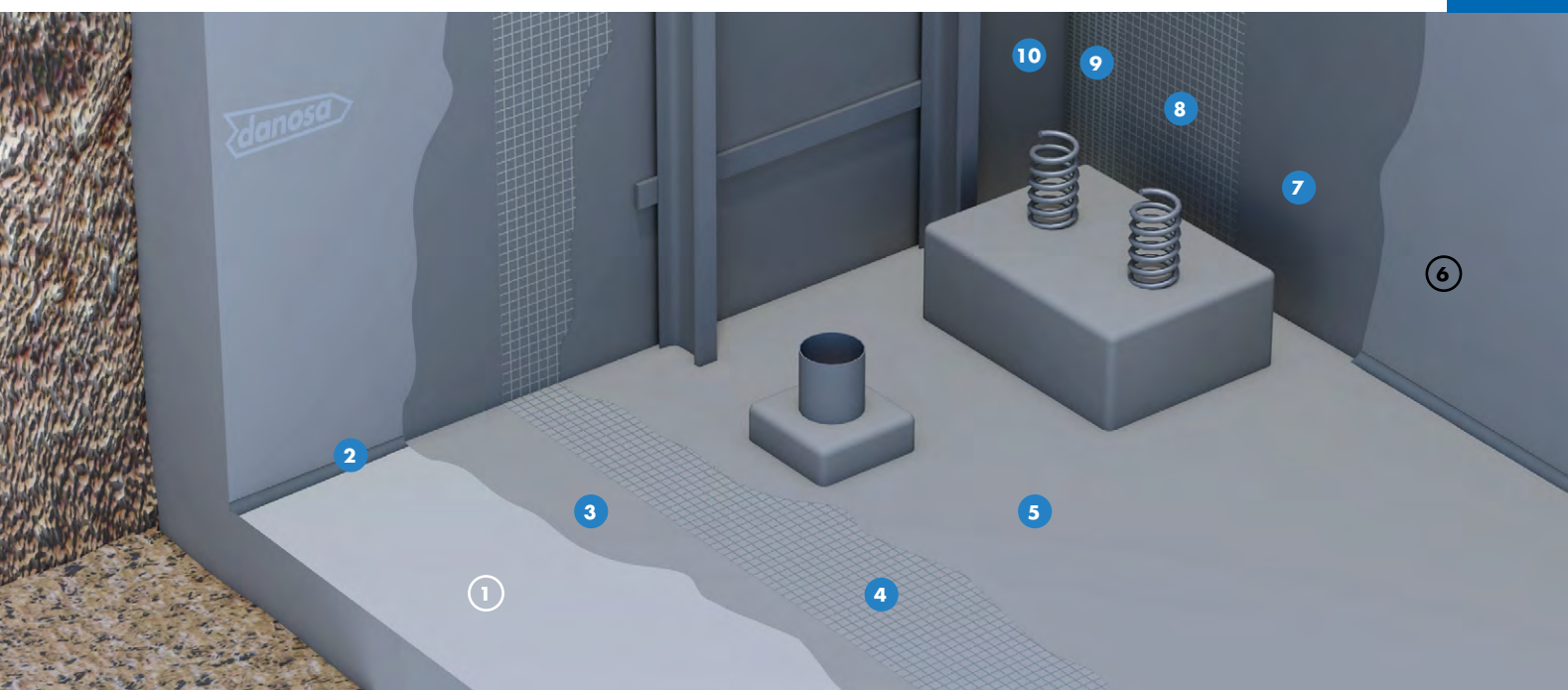

WATERTIGHTNESS DANOCRET® PROTECT 300 FLEX or 500 FLEX

ADVANTAGES

- Waterproofing with no joins or overlaps.
- Support protection.
- Easy to apply.
- Elasticity that ensures crack bridging.
- High protection against saltpetre and sea water.
- Resistant to ultraviolet radiation.

APPLICATION

- Waterproofing terraces and balconies.
- Waterproofing bathrooms, kitchens, swimming pools, changing rooms, etc.
- Waterproofing lift shafts.
- Suitable for contact with potable water.

KEY

Lift shaft:

- ① Waterproofing support
- ② Half-pipe of mortar ARGOTEC® Repair R4 Fast or reinforcing band DANO BAND® Butyl
- ③ One-component waterproofing mortar DANOCRET® Protect 300 Flex, or two-component DANOCRET® Protect 500 Flex
- ④ Glass fibre mesh 60 reinforcement
- ⑤ One-component waterproofing mortar DANOCRET® Protect 300 Flex, or two-component DANOCRET® Protect 500 Flex

Perimeter:

- ⑥ Wall
- ⑦ One-component waterproofing mortar DANOCRET® Protect 300 Flex, or two-component DANOCRET® Protect 500 Flex
- ⑧ Glass fibre mesh 60 reinforcement
- ⑨ Glass fibre mesh 60 reinforcing band
- ⑩ One-component waterproofing mortar DANOCRET® Protect 300 Flex, or two-component DANOCRET® Protect 500 Flex

LIFT SHAFT

Waterproofing: Waterproof cementitious membrane



TECHNICAL SPECIFICATIONS

Function	Product	Description	Property	Value
Waterproofing	DANOCRET® PROTECT 300 FLEX	Flexible, one-component waterproofing mortar.	Performance	3 kg/m ²
	DANOCRET® PROTECT 500 FLEX	Flexible, two-component waterproofing mortar.	Performance	3 kg/m ²
Dimensional stability	Glass fibre mesh 60	Anti-alkaline, glass fibre mesh.	Grammage	60 g/m ²

WORK UNIT

Waterproofing and protection of walls, comprising:

Preparation of the support ensuring it is left clean and firm, and then dampen it; layer of one-component flexible waterproofing mortar DANOCRET® PROTECT 300 FLEX, or two-component DANOCRET® PROTECT 500 FLEX; anti-alkaline glass fibre mesh 60 of 60 g/m²; second layer of one-component flexible waterproofing mortar DANOCRET® PROTECT 300 FLEX, or two-component DANOCRET® PROTECT 500 FLEX, on the glass fibre mesh 60 of 60 g/m²; after eight hours apply another layer of mortar DANOCRET® PROTECT 300 FLEX or 500 FLEX as a finishing coat (total consumption: approximately 3 kg/m²).

Includes proportional part of: Joins with facing comprising: one-component flexible mortar DANOCRET® PROTECT 300 FLEX, or two-component DANOCRET® PROTECT 500 FLEX; glass fibre mesh 60 of 60 g/m²; one-component flexible DANOCRET® PROTECT 300 FLEX, or two-component DANOCRET® PROTECT 500 FLEX; after eight hours apply another layer of mortar DANOCRET® PROTECT 300 FLEX or 500 FLEX as a finishing coat.

Products bearing the European CE marking.

REV00-02/2023

POTABLE WATER TANKS WITH CEMENTITIOUS MEMBRANE

Waterproofing: Waterproof cementitious membrane
Support: Concrete, mortar



Certification: Spanish R.D.
No. 140/2003 and EN 1186-3

DEP4

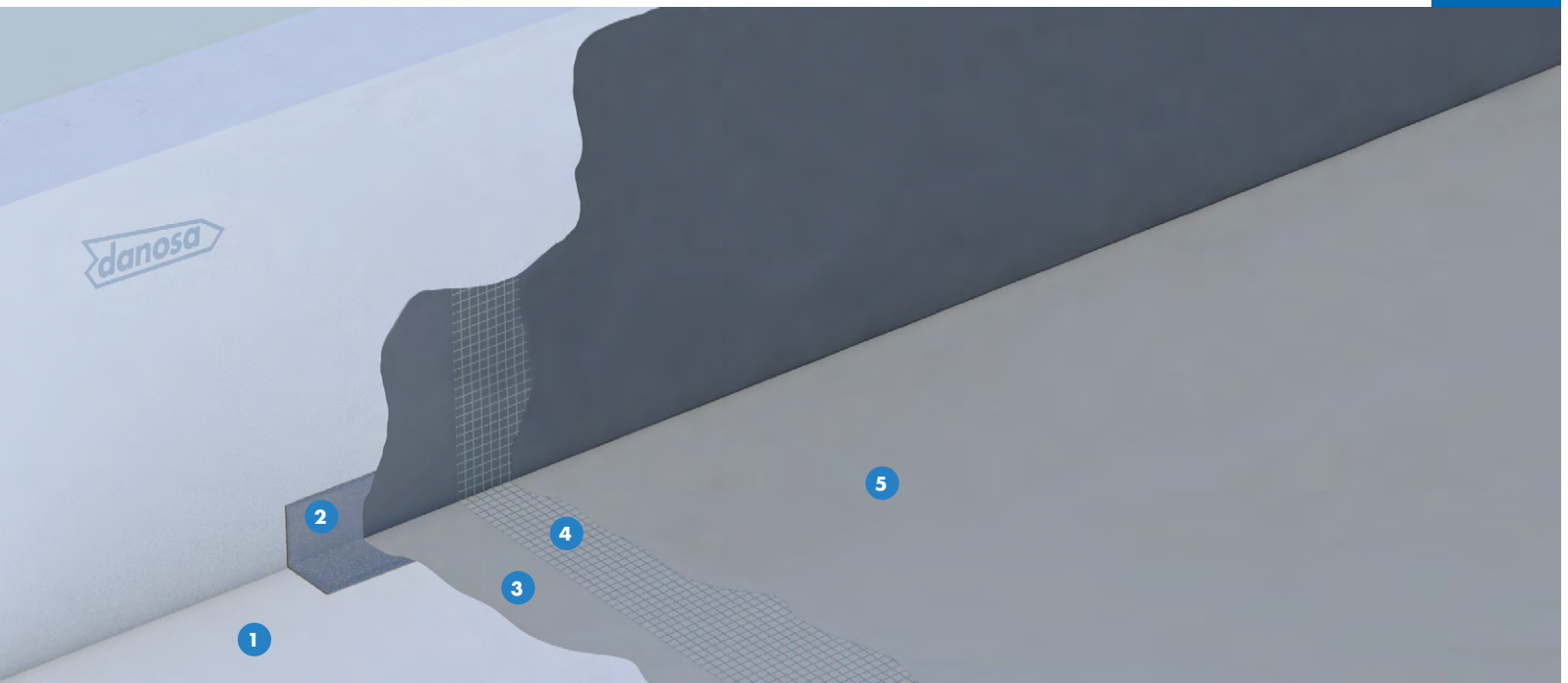

WATERTIGHTNESS DANOCRET® PROTECT 300 FLEX or 500 FLEX

ADVANTAGES

- Waterproofing with no joins or overlaps.
- Easy to apply.
- Adaptable to complicated support geometries.
- Waterproofing system with excellent mechanical resistance to abrasion and changes in temperature.
- Elasticity that ensures crack bridging.

APPLICATION

- Potable water tanks, cisterns and irrigation systems.
- Fire-fighting tanks (fire prevention).

PRECAUTIONS

- Entry into service must be later than seven days if in contact with water.

KEY

Tank:

- 1 Waterproofing support ARGOTEC® Cosmetic R2
- 2 Half-pipe of mortar ARGOTEC® Repair R4 Fast or reinforcing band DANOBAND® Butyl
- 3a One-component cementitious waterproofing membrane DANOCRET® Protect 300 Flex
- 3b Two-component cementitious waterproofing membrane DANOCRET® Protect 500 Flex
- 4 Glass fibre mesh 60 reinforcement
- 5a One-component cementitious waterproofing membrane DANOCRET® Protect 300 Flex
- 5b Two-component cementitious waterproofing membrane DANOCRET® Protect 500 Flex

POTABLE WATER TANKS WITH CEMENTITIOUS MEMBRANE



Waterproofing: Waterproof cementitious membrane
Support: Concrete, mortar

Certification: Spanish R.D.
No. 140/2003 and EN 1186-3

TECHNICAL SPECIFICATIONS

Function	Product	Description	Property	Value
Support	ARGOTEC® Cosmetic R2	Non-structural repair and concrete surface protection mortar.	Performance	1 kg/m ²
Waterproofing	DANOCRET® PROTECT 300 FLEX	Flexible, one-component waterproofing mortar.	Performance	3 kg/m ²
	DANOCRET® PROTECT 500 FLEX	Flexible, two-component waterproofing mortar.	Performance	3 kg/m ²
Dimensional stability	Glass fibre mesh 60	Anti-alkaline, glass fibre mesh.	Grammage	60 g/m ²

WORK UNIT

Potable water tank comprising:

Clean, firm support free from ridges and treated with ARGOTEC® Cosmetic R2 if there is a failure in the planimetry, as well as blinding of the perforations in the formwork, if any; damping of the support, where appropriate, application of a first coat of one-component flexible waterproofing mortar DANOCRET® PROTECT 300 FLEX, or two-component DANOCRET® PROTECT 500 FLEX; anti-alkaline glass fibre mesh 60 of 60 g/m², if the lengths of the sections exceed 6 m or if indicated by the project manager; with the mesh now firmly attached by the first coat, apply the second coat of the waterproofing membrane

DANOCRET® PROTECT 300 FLEX or 500 FLEX, and, after a few minutes, complete a third intersecting coat for a total of 3 kg/m².

Includes proportional part of treatment for the angles using a half-pipe of ARGOTEC® Repair R4 Fast or placing DANOBAND® Butyl. Important, the membrane will be operational after seven days, when it is watertight and all its components are fixed.

Products bearing the European CE marking according to EN 1504-2.

REV00-02/2023



WATERPROOFING

DANOCRET® PROTECT 300 Flex

FLEXIBLE CEMENTITIOUS MEMBRANE FOR WATERPROOFING POTABLE WATER TANKS, LIFT SHAFTS, SWIMMING POOLS, TERRACES, UNIQUE POINTS AND SURFACE PROTECTION FOR CONCRETE. ONE-COMPONENT



20KG 5KG

TOOLS



PERFORMANCE

± 3 kg/m²

DRYING TIME



Made with sulphate-resistant cement



Waterproof



Effective with pressurised water



Resistant to cold/heat



Suitable for potable water



High flexibility



Stops fissures



High adherence

DANOCRET® Protect 300 Flex is a flexible, waterproof, one-component PCC cementitious membrane to protect the surface and waterproof concrete and mortar. Made with a base of hydraulic binders, selected aggregates and polymers that grant it excellent elasticity, adherence and waterproofing ability.

ADVANTAGES

- Waterproof.
- Trafficable system under tile.
- High flexibility and adherence.
- Elasticity that ensures crack bridging of up to 1.26 mm.
- Very high adherence in non-glazed supports (2.5 N/mm², method EN 1542).
- Resistant to negative pressures (up to 5.5 atm) and positive pressures.
- Resistant to frosting/defrosting cycles.
- Prevents damp caused by condensation and the appearance of efflorescence.
- High protection against saltpetre and sea water according to UNE EN 1504-2.
- Compatible with potable water, Royal Decree 140/2003.
- Suitable for protection against carbonation.
- Compatible with ARGOCOLA® ELITE 500 C2TE S1.

APPLICATION

- Waterproofing terraces, balconies and windowsills.
- Waterproofing bathrooms, kitchens and swimming pools before installing the final cladding.
- Suitable for reducing damp caused by capillarity in buried structures and lift shafts.
- Suitable for contact with potable water, in accordance with the requirements set out in Spanish Royal Decree 140.
- Effective as a waterproof, flexible barrier for renders with micro-fissures.
- Protection of concrete surfaces against sea water and salts.

SUPPORTS

- Concrete and mortar renders.
- Ceramic and natural stone cladding.
- Plasterboard.

FLEXIBLE CEMENTITIOUS MEMBRANE FOR WATERPROOFING POTABLE WATER TANKS, LIFT SHAFTS, SWIMMING POOLS, TERRACES, UNIQUE POINTS AND SURFACE PROTECTION FOR CONCRETE. ONE-COMPONENT

APPLICATION METHOD

- Before applying the product, check the application surface is dry, clean and free from solid remains or irregularities.
- Protect yourself when handling components by wearing the right gloves and mask. Consult the safety data sheet.
- Apply to fissures and joints first. We recommend using the 4x4 mm glass fibre mesh 60.
- If reinforcing, use a trowel/roller/spraying machine to apply the first coat and install glass fibre mesh 60 reinforcement, including on the angles, before it dries.
- Apply all other coats intersecting the previous coat for a better result (consult drying time).

APPLICATION TEMPERATURE

- Between 8°C and 30°C.

DRYING TIME

- To apply another coat:
Summer: 4 h Winter: 6 to 8 h
- For coats: 48 h at 20°C, 5 days at 10°C.

STORAGE AND SHELF LIFE

- Keep the package hermetically sealed and protected from extreme temperatures and sun exposure.
- Store the product between 5°C and 30°C for a maximum of 12 months.

PRECAUTIONS

- Once the mix has been made, it must be applied in a maximum of 30 minutes.
- We recommend applying a minimum of two coats of product with each coat at least 1 mm thick.
- Trafficable after 24-48 hours of drying.
- Wet porous supports well before applying the first coat as a primer.
- Entry into service must be later than seven days if in contact with water.
- Clean tools with water as soon as you have finished. If they have any solid remains, scrape these off.
- Do not apply to hot supports or when there is a chance of rain.
- Perform material assessments to ensure correct performance and prevent an accumulation of material by preparing the supports and creating half-pipes with the most suitable product from the ARGOTEC® REPAIR range. If a half-pipe cannot be made on the straight angles, use DANOBAND® Butyl.

TECHNICAL DATA

Appearance	PCC mortar (cement, aggregates and additives)
Colour	White / Grey
Bulk density	1.50 ± 0.05 kg/dm ³
pH	10.5± 0.5
Solids content (comp. B)	57± 2
Thickness to apply	2 mm < and < 3 mm
Thickness per coat	Never more than 2 kg/m ²
Waterproof to water in liquid form and capillary absorption (EN 1062-3)	W = 0.04 kg/(m ² · h ^{0.5})
Negative pressure	Up to 5.5 atm
Resistant to cracking (EN 1062-7)	Class A4 (at 0°C)
Crack elongation capacity (EN 14891 Sec. A.8.2)	1.26 mm (coat of 2 mm at 23°C)
Direct traction adherence (EN 1504-1:2005)	1.8 N/mm ² (method EN 1542)
Adherence after thermal compatibility (EN 13687-1 and 2)	1.5 N/mm ² (method EN 1542)
Classification according to EN 14891 table 4	MC01P
Permeability to CO ₂ in m (EN 1062-6 2003)	Class III
Permeability to water vapour (EN ISO 7783.2018)	Class I



WATERPROOFING

DANOCRET® PROTECT 500 Flex

FLEXIBLE CEMENTITIOUS MEMBRANE FOR WATERPROOFING POTABLE WATER TANKS, LIFT SHAFTS, SWIMMING POOLS, TERRACES, UNIQUE POINTS AND SURFACE PROTECTION FOR CONCRETE. TWO-COMPONENT

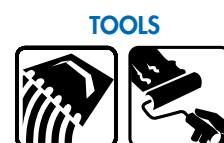

TOOLS



PERFORMANCE

± 3 kg/m²

DRYING TIME



4-8h



Made with sulphate-resistant cement



Waterproof



Effective with pressurised water



Resistant to cold/heat



Suitable for potable water



High flexibility



Stops fissures



High adherence

DANOCRET® Protect 500 Flex is a flexible, waterproof, two-component PCC cementitious membrane to protect the surface and waterproof concrete and mortar. Made with a base of hydraulic binders, selected aggregates and polymers that grant it excellent elasticity, adherence and waterproofing ability.

ADVANTAGES

- Waterproof.
- Trafficable system under tile.
- High flexibility and adherence.
- Elasticity that ensures crack bridging of up to 2.50 mm.
- Good adherence in non-glazed supports (1.1 N/mm², method EN 1542).
- Resistant to negative and positive pressures.
- Resistant to frosting/defrosting cycles.
- Prevents damp caused by condensation and the appearance of efflorescence.
- High protection against saltpetre and sea water according to UNE EN 1504-2.
- Compatible with potable water, Royal Decree 140/2003.
- Suitable for protection against carbonation.
- Compatible with ARGOCOLA® ELITE 500 C2TES1.

APPLICATION

- Waterproofing terraces and balconies.
- Waterproofing bathrooms, kitchens and swimming pools before installing the final cladding.
- Suitable for reducing damp caused by capillarity in buried structures and lift shafts.
- Suitable for contact with potable water, in accordance with the requirements set out in Spanish Royal Decree 140.
- Effective as a waterproof, flexible barrier for renders with micro-fissures.
- Protection of concrete surfaces against sea water and salts.

SUPPORTS

- Concrete and mortar renders.
- Ceramic and natural stone cladding.
- Plasterboard.

FLEXIBLE CEMENTITIOUS MEMBRANE FOR WATERPROOFING POTABLE WATER TANKS, LIFT SHAFTS, SWIMMING POOLS, TERRACES, UNIQUE POINTS AND SURFACE PROTECTION FOR CONCRETE. TWO-COMPONENT

APPLICATION METHOD

- Before applying the product, check the application surface is dry, clean and free from solid remains or irregularities.
- Protect yourself when handling components by wearing the right gloves and mask. Consult the safety data sheet.
- Mix the two components in the plastic packaging until smooth.
- Apply to fissures and joints first. We recommend using the 4x4 mm glass fibre mesh 60.
- If reinforcing, use a trowel/roller/spraying machine to apply the first coat and install glass fibre mesh 60 reinforcement, including on the angles, before it dries.
- Apply all other coats intersecting the previous coat for a better result (consult drying time).

APPLICATION TEMPERATURE

- Between 8°C and 30°C.
- In applications with high temperatures, moisten the support.

DRYING TIME

- To apply another coat:
Summer: 4 h Winter: 6 to 8 h
- For coats: 48 h at 20°C, 5 days at 10°C.

STORAGE AND SHELF LIFE

- Keep the package hermetically sealed and protected from extreme temperatures and sun exposure.
- Store the product between 5°C and 30°C for a maximum of 12 months.

PRECAUTIONS

- Once the mix has been made, it must be applied in a maximum of 30 minutes.
- We recommend applying a minimum of two coats of product with each coat at least 1 mm thick.
- Trafficable after 24-48 hours of drying.
- Wet porous supports well before applying the first coat as a primer.
- Entry into service must be later than seven days if in contact with water.
- Clean tools with water as soon as you have finished. If they have any solid remains, scrape these off.
- Do not apply to hot supports or when there is a chance of rain.
- Perform material assessments to ensure correct performance and prevent an accumulation of material by preparing the supports and creating half-pipes with the most suitable product from the ARGOTEC® REPAIR range.
- Do not reuse packaging.

TECHNICAL DATA

Appearance component A	PCC mortar (cement, aggregates and additives)
Appearance component B	White viscous liquid
Density (comp. A and comp. B)	1.80 ± 0.05 kg/dm ³ and 1.04 ± 0.01 kg/dm ³
pH (comp. A and B)	10.5 ± 0.5 and 7.5 ± 0.5
Solids content (comp. B)	57 ± 2
Thickness to apply	2 mm < and < 3 mm
Thickness per coat	Never more than 2 kg/m ²
Waterproof to water in liquid form and capillary absorption (EN 1062-3)	W = 0.01 kg/(m ² · h ^{0.5})
Negative pressure	Up to 2.5 atm
Resistant to cracking (EN 1062-7)	Class A5 (at 0°C)
Crack elongation capacity (EN 14891 Sec. A.8.2)	2.50 mm (coat of 2 mm at 23°C)
Direct traction adherence (EN 1504-1:2005)	1.1 N/mm ² (method EN 1542)
Adherence after thermal compatibility (EN 13687-1 and 2)	1.0 N/mm ² (method EN 1542)
Classification according to EN 14891 table 4	MC02P
Permeability to CO ₂ in m (EN 1062-6 2003)	Class III
Permeability to water vapour (EN ISO 7783.2018)	Class II

REVESTIDAN®

Indoor

WATERPROOFING

ELASTIC MEMBRANE FOR
WATERPROOFING WINDOWSILLS,
BALCONIES, PARAPETS, BATHROOMS,
KITCHENS AND WET AREAS INDOORS



5kg 20kg

TOOLS



PERFORMANCE

2 kg/m²

DRYING TIME



Elastic, one-component liquid membrane to protect and waterproof vertical and horizontal facing prior to installing the final cladding.

ADVANTAGES

- Waterproofs, forming a continuous film with no joints.
- Excellent elasticity, effective at bridging cracks in the support of up to 3.42 mm.
- Good adherence to the support, even wet supports.
- Good adherence of the adhesive cement to the product for installation of the final cladding with resistance to the initial adhesion of 1.3 N/mm², with cohesive failure of the adhesive cement.
- Easy to apply.
- Resistant to alkaline substrates.

APPLICATION

- Waterproofing flooring before installation of the final cladding: bathrooms, showers, kitchens, etc.
- Waterproofing walls before installation of the final cladding.
- Waterproofing all kinds of windowsills.

SUPPORTS

- Supports made of cement, laminated plasterboard, gypsum plasters and marine plywood.

REVESTIDAN® Indoor

ELASTIC MEMBRANE FOR WATERPROOFING WINDOWSILLS, BALCONIES, PARAPETS, BATHROOMS, KITCHENS AND WET AREAS INDOORS

APPLICATION METHOD

- Before applying the product to the support, ensure it is dry and free from solid waste or irregularities.
- Apply using a roller or brush.
- First, repair any cracks and apply DANO BAND® Butyl to the angles. On extremely porous supports, we recommend applying a primer layer of DANOPRIMER® W or REVESTIDAN® Indoor diluted in water at a proportion of 1/1.
- Once the first coat has dried, apply successive coats of undiluted product. A minimum of two additional coats is required. Wait for each coat to dry before applying the next one.
- Drying time between coats is approximately 3 hours, but this will vary depending on the room temperature and humidity. After applying the last coat, wait between 24 hours and 4 days, depending on the temperature and relative humidity, before applying the final cladding.

STORAGE AND SHELF LIFE

- Keep the package hermetically sealed and protected from extreme temperatures and sun exposure.
- Store the product between 5°C and 30°C for a maximum of 24 months.

PRECAUTIONS

- Do not use on continually flooded surfaces, swimming pools or tanks.
- Protect REVESTIDAN® Indoor from sunlight. It should always be underneath cladding.
- Clean tools with water as soon as you have finished. If they have any solid remains, scrape these off.

APPLICATION TEMPERATURE

- Between 5°C and 35°C.
- The relative humidity should be below 75%.

TESTS ON LIQUID MEMBRANES FOR WATERPROOFING, FOR USE UNDER CERAMIC TILING, EN 14891

Watertightness: Sec. A.7: Increase in weight < 20 g	No water penetration is observed, and weight increase of 2 g.
Initial adhesion resistance. Sec. A.6.2: > 0.5 N/mm ²	1.3 N/mm ² . Cohesive failure of ceramic adhesive.
Resistance to adhesion after immersion in water. Sec. A.6.4: > 0.5 N/mm ²	0.8 N/mm ² . Cohesive failure of ceramic adhesive.
Resistance to adhesion after heat. Sec. A.6.5: > 0.5 N/mm ²	1.3 N/mm ² . Cohesive failure of ceramic adhesive.
Resistance to adhesion after frosting/defrosting cycles. Sec. A.6.6: > 0.5 N/mm ²	0.8 N/mm ² . Cohesive failure of ceramic adhesive.
Resistance to adhesion after immersion in hard water. Sec. A.6.5: > 0.5 N/mm ²	0.7 N/mm ² . Cohesive failure of ceramic adhesive.
Crack elongation capacity. Sec. A.8.2 > 0.75 mm	3.42 mm (at 23°C)

TECHNICAL DATA

Appearance/Colours	Blue paste
Density	1.45 ± 0.05 g/cm ³
Stormer viscosity at 23°C	145 ± 5 KU
Solids content	± 69.5% by weight
No. recommended coats	2 to 3
Drying time at 20°C, 50% RH	± 3 hours



Sustainable solutions for people's comfort and quality of life



WATERPROOFING, INSULATION AND MORTARS FOR NEW CONSTRUCTION AND REHABILITATION

Discover a world of DANOSA solutions
www.danosa.com

DANOSA ESPAÑA

Factory, Central Offices and Logistics Center

Polígono Industrial. Sector 9.
19290 Fontanar, Guadalajara, España

Tel.: (+34) 949 888 210
info@danosa.com

DANOSA UK

Independence Unit 3, Stanbridge Road.
PO9 2NS Havant, Hampshire, United Kingdom.

Tel.: (+44) 8450 740 553
uk@danosa.com

DANOSA PORTUGAL

Rua do Norte, Lugar da Quinta do Aduguete.
3100-342 Pombal, Portugal

Tel.: (+351) 236 029 465
portugal@danosa.com

DANOSA FRANCE

12, Avenue Arago.
91420 Morangis, France

Tel.: (+33) 0 141 941 890
france@danosa.com

DANOSA MAROC

14, Bd de Paris, 5ème Etage. Bureau n° 48.
Casablanca, Maroc

Tel.: (+212) 522 221 153
maroc@danosa.com

DANOSA ANDINA

Cra. 7 #82-66. Oficina 311
Bogotá D.C., Colombia

Tel.: (+57) 3173 729 559
andina@danosa.com

DANOSA MÉXICO

Tel.: +00 52 155 356 769 52
mexico@danosa.com

TIKIDAN

Tikitar Estate, Village Road, Bhandup (West)
400 078, Mumbai, India.

Tel.: (+91) 2241 266 666
info@tikidan.in



Download BIM libraries
for products and systems



DANOSA UK



DANOSA UK



DANOSAUK



DANOSA UK